

Armored Ford F-350 – Technical Specifications

DIMENSIONS*	
Length	6,351mm
Height	2,065mm
Width	2,031mm
Seats	6 seats (Driver + 5 Passengers)
* subject to final	configuration
WEIGHT ARMORED *	
Curb Weight	4,703 Kg*
Payload Capacity	500 Kg* (Optional 1300 kg)
Gross Vehicle Weight (GVW)	Gross vehicle weight: 5,216 kg (Optional 6000 kg)
PROTECTION	
Crew Compartment	FB7 according to EN1522 / STANAG II
Floor	DM51 as standard; Optional STANAG 4569 Level I and Mine protection
ENGINE	
Engine	6.7 L 4 Valve Power Stroke® Diesel V8 Engine
Engine Output	440 hp @ 2,800 rpm
Engine Torque	127 KgM @ 1,600 rpm
Wheel Drive	Selectable Four-wheel drive (4x4); Automatic
Chassis – Commercial Ford F-350	

(*) Specifications and illustrations are as accurate as known at the time of publication, and are subject to changes without notice. Not all options can be specified together.

*Subject to protection level, option installed and crew

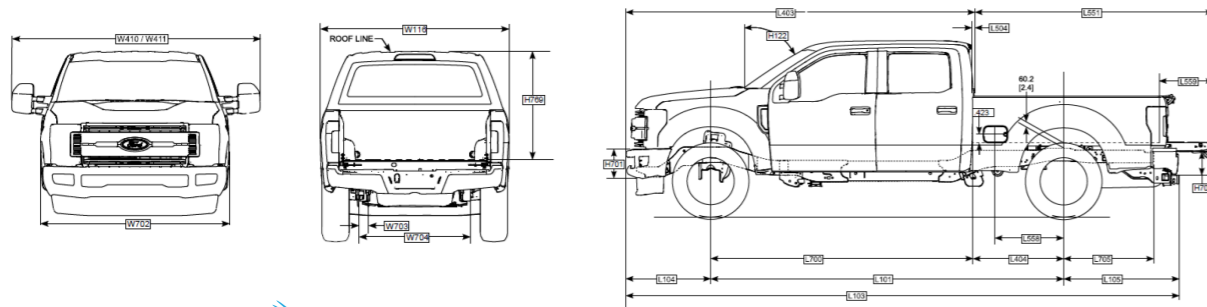

Re'em Armored Ford F-350

- Rugged, durable, with the ability to handle anything
- Suitable for SOF requirements
- Strong, secure, able to carry heavy loads
- A reliable and dependable workhorse

Re'em Armored Ford F-350

Rugged, durable, with the ability to handle anything

Re'em designed and modified a commercial Ford F-350 into an armored off-road pickup. The overall weight has been increased to 6000 kg with 1300 kg payload. Famed as one of the most rugged and durable pickups ever, the Re'em armored Ford F-350 takes that strength to a new level. Whether it is off road, over obstacles, or up the steepest gradients, the Ford F-350 can take it.

Suitable for SOF requirements

Plasan Re'em provides SOF operators with covert mobility by acquiring commercial vehicles that are representative of indigenous operating environments and modified to meet SOF-unique requirements.

High-End Internal Design



Strong, secure, able to carry heavy loads

The Re'em armored Ford F-350 passenger module is compact and strong, providing the secure space needed to get up to 5 passengers and their equipment through dangerous situations. Armor panels, passenger module, structural reinforcements, along with high-performance suspension and electrical systems, give the Re'em Ford-350 strength and the ability to handle anything.

A reliable and dependable workhorse

A rugged, extra strong vehicle able to carry heavy loads and absorb the stresses of rough terrain and even rougher treatment, the Re'em armored Ford F-350 is the result of long-term design evolution and numerous innovations. Carefully designed for weight control, utilizing Plasan Re'em light weight solutions (52-60 kg/m², multi-hit 25mm between shots) and strength, the finished product looks like a standard civilian model – but has military grade strengths.



Highly Covert



STANAG 2



Automotive Upgrades



Military Use



Run-Flat Devices



Self Assembly



Special Forces use



High Mobility



aRweem*